

# 48 Series FPS Series

Fluorescent Inverters



## 48 Series remote inverters and FPS Series self-powered inverters

The **48** and **FPS Series** of emergency ballasts are used to convert new or existing fluorescent fixtures into emergency lighting units. These ballasts eliminate the cost of installation of separate emergency lighting units.

### Features

- All **FPS Series** are fully load tested prior to shipment
- Inverter is 100% solid state, short and open circuit proof
- Polarized DC input (48 Series only)
- 120Vac 60Hz input is standard, 277 and 347Vac available as options
- 25%, 50% or 80% lamp lumen output
- Mounts directly in ballast channel, remote or optional T-Bar fixture
- CSA listed





Project/Location:

Date:

Contractor:

Prepared by:

# 48 & FPS Series

## Typical Specification



**48 Series:** The electrical contractor shall supply and install Emergi-lite **48 Series** remote fluorescent inverter ballasts for each fixture as shown on plans. The inverter shall operate on \_\_\_\_\_Vdc input for \_\_\_\_\_ minutes during a power failure. The fluorescent lamp shall be maintained at \_\_\_\_\_% lumen output for one lamp only. The inverter is to be connected to the remote battery unit as shown on plans (battery unit to be selected according to voltage/wattage and duration required). The inverter shall be capable of illuminating the fluorescent lamp even when it is burned out under normal AC operation.

**FPS Series:** The electrical contractor shall supply and install Emergi-lite **FPS Series** fluorescent inverters for each fixture as shown on plans. The **FPS Series** inverter shall operate for \_\_\_\_\_ minutes during a power failure. The fluorescent lamp shall be maintained at \_\_\_\_\_% of nominal lumen output. The **FPS Series** inverter shall be capable of illuminating the fluorescent lamp even when it is out under normal AC operations.

## Dimensions

### 48 Series

48 ENCLOSURE (white) - Internal

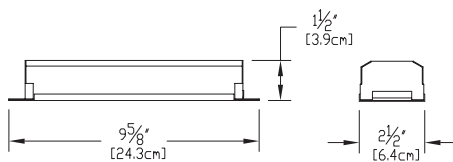

### FPS Series

INTERNAL ENCLOSURE (black)

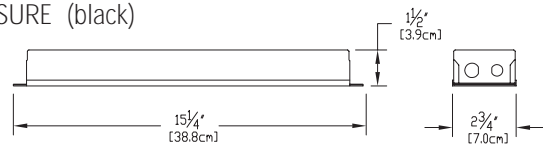

R ENCLOSURE (white)

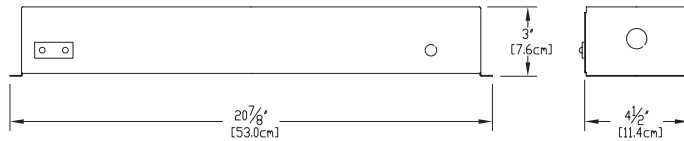

T ENCLOSURE (factory white)

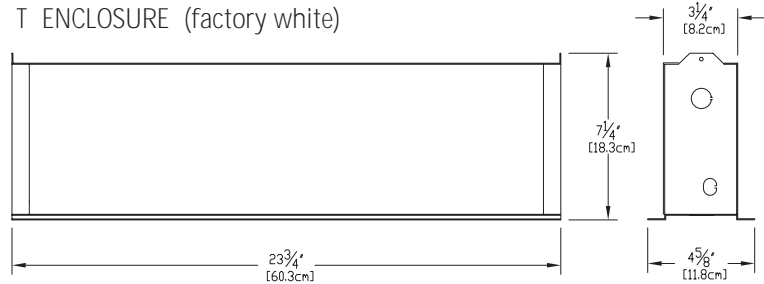

## Ordering Information

### 48 Series

Series	Lumens / % for 48" Tube	A.C. Voltage
4806= 6 volts	-25= 25% (800 lumens)	Blank= 120Vac
4812= 12 volts	-60= 50% (1600 lumens)	-2= 277Vac
4824= 24 volts	-100= 80% (2560 lumens)	-3= 347Vac
4832= 32 volts		
4848= 48 volts		
48120= 120 volts		

EXAMPLE: 4812-25-3

### FPS Series

Series	Lumens / % for 48" Tube	Min. Runtime	Housing	A.C. Voltage
FPS= series	25= 25% (800 lumens)	/30= 30 minutes	* Blank= internal	Blank= 120Vac
	60= 50% (1600 lumens)	/60= 60 minutes	R= remote mounting enclosure	-2= 277Vac
	100= 80% (2560 lumens)	/90= 90 minutes	T= T-Bar	-3= 347Vac
		/120= 120 minutes *	* Not available for FPS100.	
		* in T-Bar cabinet only		

EXAMPLE: FPS60/30

Lumen outputs based on averages.  
 24"/20W=1260 48"/40W=3200 96"/75W=6300  
 Inverters will operate T12, T8, or "U" type lamps.