

EMERGI-LITE®

New York City Offering

Your solution to emergency lighting



ON THE PROJECT, ON THE SHELF, ON THE JOB

Thomas & Betts
A Member of the ABB Group

Emergi-Lite® is proud to present a complete range of New York City–Approved life safety equipment for commercial and institutional environments, all using LED light source.

Product List



NYC Approved LED Exit & Combo Series

P. 2



NYC Approved LED Battery Series

P. 3



NYC Approved Total™ Edge Series

P. 4



FPDL Series Emergency Ballast

P.5



Revelation™ Series

P.6



Mini-Revelation™ Series

P. 7



CCTS Battery Series

P. 10-11



CCJSM Battery Series

P. 12



TYPE: _____
 CATALOG #: _____
 NOTES: _____

NYC Approved LED Exit & Combo Units

Commercial Unit Equipment Combination
 Emergency Light and 8" Exit Sign

The LED NYC Economizer™ Series are designed and manufactured specifically to meet New York City's local code requirements for places of public assembly. This series combines 7.2V, 2/3-heads emergency lighting with an 8 inch, Self-Powered exit sign in one compact easy-to-install unit. Also available in an 8 inch steel exit Self-Powered.

Features

- 20 gauge heavy duty steel case with white powder-coat finish
- Stencil face has 8" high letters and universal knock out chevrons
- 2 or 3 glare free, adjustable round heads
- Plastic lamp housing with rated 5VA flame retardant
- Exit Sign can be ceiling, end or wall mounted
- Combination units can be wall and side mounting
- 3 (1W) LED lamps, 100 lumens per lamp in combination heads
- LED Exit Legend illumination
- Single or double face universal design
- 120V/277V Operation standard
- Universal 120/277 VAC transformer required
- Nickel-Cadmium Battery
- Suitable for Damp Location
- Complies with NEC, Life Safety Code and OSHA
- UL924 Listed
- Unit has a three year full warranty (excluding lamps and pilot lights)
- Nickel-Cadmium battery has a five year full, plus five year pro-rata warranty
 Detailed warranty terms located at: www.emergi-lite.com/usa/files/EL_Warranty.pdf

Dimensions

Dimensions are approximate and subject to change.

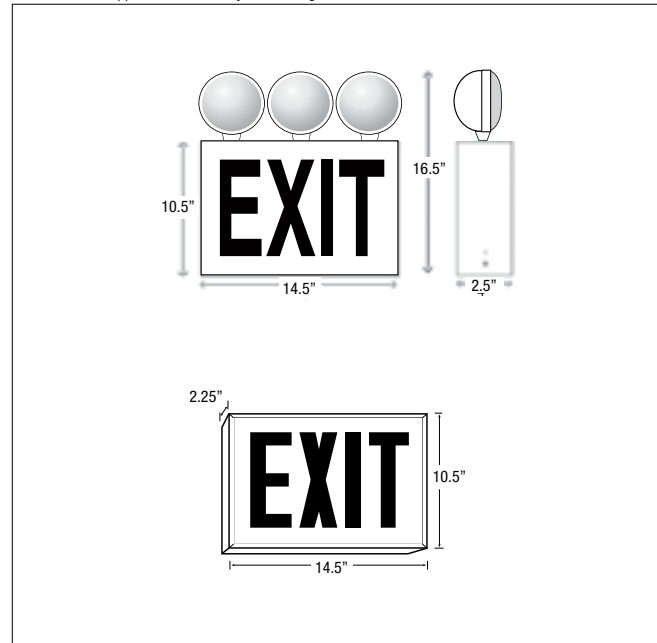

Unit Selection Chart

SERIES	DESCRIPTION	COLOR	STENCIL	INPUT
8NY-N-R-N	8" Exit Self-Powered	White	Red	120/277VAC, 60Hz 0.034A / 0.017A
8NY-2/3R-LED-N	8" Combo 2/3 Heads	White	Red	120/277VAC, 60Hz 0.035A/0.016A

Example: 8NY-N-R-N

TYPE: _____
 CATALOG #: _____
 NOTES: _____



NYC Approved LED Battery Series

Features

- Constructed of 20 guage heavy-duty steel and a durable white powder-coat finish
- The NYLED-2/3 unit is furnished with adjustable 2 or 3 glare free heads (1W LED) and the NYLED-2 unit is furnished with 2 (1W LED) heads
- Each head provides 100 lumens output
- 120V/277V Input standard
- Low voltage disconnect prevents over discharge of battery
- Brownout protection standard
- 3.6V Nickel-Cadmium battery
- UL924 Listed
- Complies with NEC, Life Safety Code and OSHA
- Unit has a three year full warranty (excluding lamps and fuses)
- Nickel-Cadmium battery has a five year full, plus five year pro-rata warranty
 Detailed warranty terms located at: www.emergi-lite.com/usa/files/EL_Warranty.pdf

Dimensions

Dimensions are approximate and subject to change.

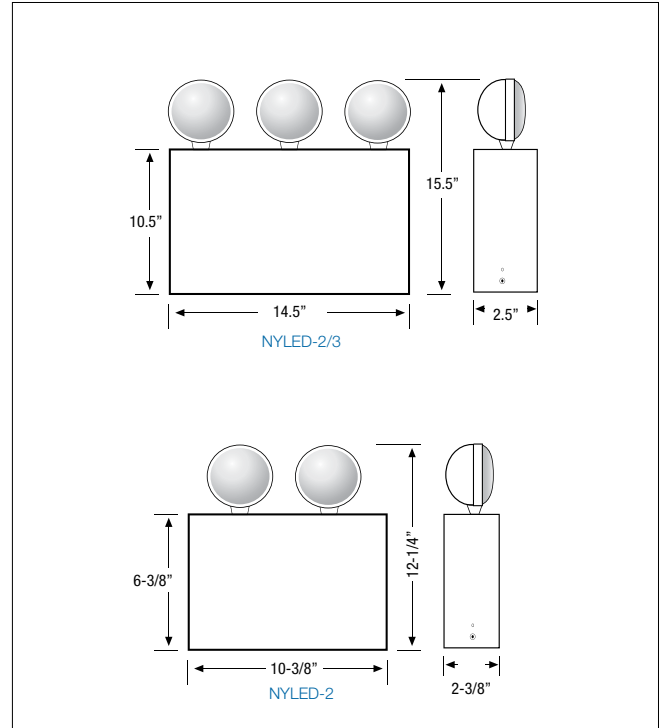

Unit Selection Chart

SERIES	D.C VOLTAGE	NUMBER OF HEADS	COLOR
NYLED-2	3.6V	2 X 1W LED lamps	White
NYLED-2/3	3.6V	3 X 1W LED lamps	White

Example: NYLED-2



TYPE: _____
 CATALOG #: _____
 NOTES: _____

NYC Approved Total Edge™ Series

Surface and Recessed Mount Edge-Lit Exit Sign

Standard Features

- Universal mount, surface, recessed or end-mount
- High performance low power consumption LEDs
- Peel-off chevrons
- Special wording panel not available
- Suitable from Damp Location
- Complete product only available in single face red on clear
- Double face red on mirror panel sold separately

Construction

- Brushed aluminum housing, gray plastic end-caps, with high grade acrylic panel and thermoplastic canopy
- Choice of legend colors: red on clear on single face unit and red on mirror for double face panel

Electrical

- Dual-voltage input capability 120/277VAC
- Self-powered models feature battery delivering more than 90 minutes capacity in emergency mode

Installation

Universal mount

Surface mount: Pivoting panel design allows for surface installation in any applications, including ceilings and walls.

Semi recessed mount

Includes back box and necessary hardware for joist or T-Bar* ceilings and is vertically adjustable to install in most ceiling thickness. Mounting bars lock in place with two screws.

Listings

- UL924 Listed

Warranty

- 3-year limited warranty
- Detailed warranty terms located at: www.emergi-lite.com/usa/files/EL_Warranty.pdf

* Not intended for closed ceilings such as sheet-rock or plaster.

Unit Selection Chart

AG	PN	1	R	C	8
----	----	---	---	---	---

HOUSING COLOR	SERIES	FACES	COLOR	PANEL BACKGROUND-COLOR	LEGEND
AG= Brushed aluminum and gray end cap	PN= Self-Powered	1= Single	R= Red	C= Clear (Single face)	8= 8" with universal chevrons

PANEL: TEP2RM8= Panel only, double face red on mirror

AG	PN	3	R	CM	8
----	----	---	---	----	---

HOUSING COLOR	SERIES	FACES	COLOR	PANEL BACKGROUND-COLOR	LEGEND
AG= Brushed aluminum and gray end cap	PN= Self-Powered	3= Universal	R= Red	CM= Clear (Single face) and Mirror (Double face)	8= 8" with universal chevrons

Dimensions

Dimensions are approximate and subject to change.

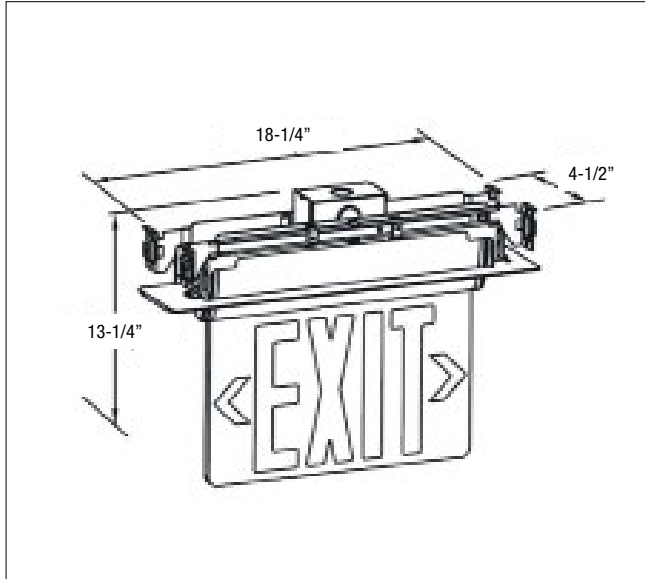

Unit Rating Chart

MODEL		AC SPECS		DC SPECS	
Red	Self-Powered	120VAC, 60Hz	2.0-2.6W	Ni-Cd battery	Min. 90 Minutes
		277VAC, 60Hz	2.6-3.1W	Ni-Cd battery	Min. 90 Minutes

TYPE: _____
 CATALOG #: _____
 NOTES: _____



FPDL Series Fluorescent Emergency Lighting Ballasts

Six models meet different application requirements:

- **FPDL-32** 500 lumens emergency ballast operates with most 2'-4' T8 linear fluorescent lamps and also with 28W T5 lamps
- **FPDL/U** 1400 lumens emergency ballast operates with most 2'-4' T8 and T5 linear fluorescent lamps and also with most 4-pin compact fluorescent lamps
- **FPDL13-42-N** 650 lumens emergency ballast operates with most 13-42W 4-pin quad and triple tube fluorescent lamps with one or two lamps (max. 18W)
- **FPDL-28** 700 lumens emergency ballast operates with most 2'-4' T8 and T5 linear fluorescent lamps
- **FPDL-HL-N** is a high-output emergency ballast capable of producing up to 3000 lumens

Features

- Compatible with standard, energy-saving, dimming and electronic AC ballasts
- Can be wired to operate with switched, un-switched or normally-off fixtures without affecting normal operation
- Sealed, maintenance-free Nickel-Cadmium batteries
- Upon failure of AC power, the FPDL-32 model automatically switch to emergency mode, maintaining illumination of one lamp within the fixture. FPDL/U, FPDL13-42-N, FPDL-28 and FPDL-HL-N units will maintain operation of one or two lamps when switched to the emergency mode
- When AC power is restored, the FPDL Series automatically returns the fluorescent lamps to normal operating mode and the solid state charger begins recharging the battery
- Self-contained in one compact housing for easy installation and maximum mounting flexibility
- UL Listed for damp locations to Standard 924; complies with NEC, Life Safety Code and OSHA, and field installation
- 3-year full warranty
- Each unit is fully computer tested

Dimensions

Dimensions are approximate and subject to change.

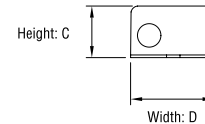
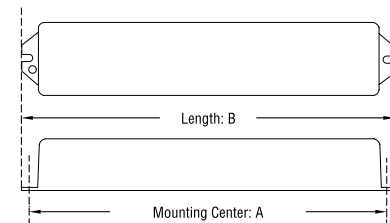

Cabinet Size	Dimensions			
	a	b	c	d
FPDL-32	9-1/2"	10-1/8"	1-1/8"	2-1/8"
FPDL/U	13-3/4"	14-1/4"	1-1/8"	2-1/8"
FPDL13-42-N	8-7/8"	9-3/8"	1-1/4"	2-3/8"
FPDL-28	13-3/4"	14-1/4"	1-1/8"	2-1/8"
FPDL-HL-N	15-3/4"	16-1/4"	1-3/4"	5-1/2"

Accessories (order as a separate item)

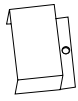
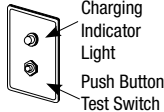
DESCRIPTION	PART NUMBER
External mounting kit includes wire bundle cover for external mounting (not needed for FPDL13-42-N and FPDL-HL-N)	EC6 
Remote test switch comes with single gang plastic mounting plate (included in FPDL13-42-N and FPDL10-26)	RTS-1 

How to Order

SERIES	
FPDL-32	FPDL-28
FPDL-U	FPDL-HL-N
FPDL13-42-N	

Example: **FPDL-32**

Power Consumption

Series	Lamp Operated in Emergency Mode*	Emergency Illumination Time	Lumens
FPDL-32	1 lamp 2'-4' (20W-40W)	90 minutes	500
FPDL/U	1 lamp 2'-8' (20W-60W) or 2 lamps 2'-4' (20W-32W)	90 minutes	1400
FPDL13-42-N	1 compact 4-pin (13W-42W) or 2 compact 4-pin (13W-18W)	90 minutes	650
FPDL-28	1 lamp 2'-4' (20W-54W) or 2 lamps 2'-4' (20W-32W)	90 minutes	700
FPDL-HL-N	- 1 lamp 2'-8' or - 2 lamps 2'-4' or - 1 compact 4-pin (18W-70W) or - 2 compact 4-pin (18W-32W)	90 minutes	3000



NYC Approved Revelation™ Series

NEW & Improved Design
THE UNSEEN SOLUTION Virtually Invisible
Emergency Lighting

TYPE: _____
 CATALOG #: _____
 NOTES: _____

The Revelation™ Series is architecturally designed for unobtrusive use in walls with cavity (dry wall with 4-inch studs) or un-insulated ceilings with horizontal beams or T-bar structures. In normal conditions (stand-by) the unit is completely concealed in the wall or ceiling. In case of power failure the door of the unit rotates open 180° and exposes the emergency lights (two high-efficiency MR16 lamps) to illuminate the path of egress.

Once AC power returns or at the end of discharge period, the lights turn off and the door rotates closed automatically, driven by a patent-pending, energy storage circuit. If needed the backbox can be shipped separately.

Features

- Reliability: Each unit is fully computer-tested and aligned mechanically for optimum operation. The electrical parts (motor, electronic circuitry) carry a five-year warranty.
- The normally exposed parts of the unit (flat door and frame) are covered with a high-quality, powder coated textured off-white finish, which integrates well with most wall and ceiling paints. The surface finish can also be customized on site with paint, wallpaper or other coverings. The self-powered unit is contained in a heavy-duty galvanized steel back-box, concealed in the wall or ceiling and includes a combined test switch and pilot light, accessible through the frame. Special bar hangers for installation in sheet rock or T-bar ceilings are included in the package. The module includes the electrical junction box and is installed on the wall stud or ceiling beam with the help of a simple, U-shape bracket. Each unit comes standard with two (2) MR-16 halogen lamps, of specified power ranging from 12W to 50Watts each.
- 120/277 Vac, 60 Hz, 0.25/0.12 Amps

Dimensions

Dimensions are approximate and subject to change.

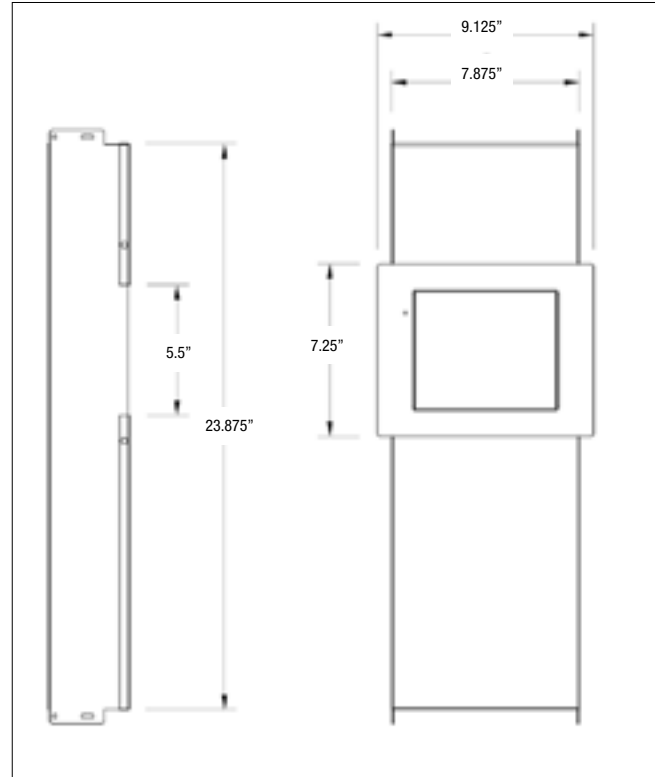

Unit Rating Chart

Sealed Maintenance-Free Battery Types	Watts to 87-1/2 % of rated battery voltage			
	1-1/2 hrs.	2 hrs.	4 hrs.	8 hrs.
RTM40, RTN40	40	30	24	-
RTM70, RTN70	70	50	40	24
RTM100, RTN100	100	70	50	40

Unit Selection Chart

Series	Battery type/Capacity	Lamp Wattage	Options
RT= Revelation	M40 = 12V, 40W, Lead-Calcium M70 = 12V, 70W, Lead-Calcium M100 = 12V, 100W, Lead-Calcium N40 = 12V, 40W, Nickel-Cadmium N70 = 12V, 70W, Nickel-Cadmium N100 = 12V, 100W, Nickel-Cadmium* *Not suitable for Damp Locations	-2(12) = 12W each head -2(20) = 20W each head -2(35) = 35W each head -2(50) = 50W each head -2(20H) = 20W, high lumen output -2(35H) = 35W, high lumen output -2(50H) = 50W, high lumen output -2 (LG) = 12V-4W, MR16 LED -2 (LJ) = 12V-5W, MR16 LED -2 (LJ) = 12V-6W, MR16 LED	AD = advanced diagnostic ADNA = advanced diagnostic, non-audible D1 = time delay 5 min D2 = time delay 10 min D3 = time delay 15 min DL = Damp Location* X = Backbox shipped separate # = See note below * DL (Damp location) 70w max for Nickel-Cadmium 100w max Lead Calcium batteries

TYPE: _____
 CATALOG #: _____
 NOTES: _____



Mini-Revelation™ Series

The Unseen Solution
 Virtually Invisible Emergency Lighting

Features

- Each unit comes with two (2) MR16 halogen lamps or 2 MR16 style LED lamps
 - The Self-Powered battery unit is contained in a heavy-duty galvanized steel back box that can be concealed in the wall or ceiling and includes a combined test switch and pilot light that is accessible through the frame
 - The normally exposed parts of the unit (flat door and frame) are covered with a high-quality powder-coated, textured off-white finish that integrates well with most wall and ceiling paints. The surface finish can also be customized on site with paint, wallpaper or other coverings
 - Power requirements: 120/277VAC, 60Hz, 0.25/0.12A
 - PulsePlus Charger - this automatic charger is built around a micro-processor integrated circuit. Circuit standard features include current limiting, temperature-compensated cut-off voltage, brownout transfer, low-voltage battery disconnect and battery lock out (prevents activation in DC mode until initial AC activation)
 - The equipment includes an electrical junction box and can be installed on a wall stud or ceiling beam with a simple U-shape bracket
 - AD or ADNA options include includes a Time Delay function. If needed, it can be enabled/disabled in the field or it can be preset at the factory by including the suffix AD-D_ or ADNA-D_
 - CSA US Certified
 - Evaluated to UL 924 Standard
 - 5-year warranty on electrical parts (motor, electronic circuitry). Each unit is fully computer-tested and aligned mechanically for optimum operation
- Detailed warranty terms located at: www.emergi-lite.com/usa/files/EL_Warranty.pdf

Accessories (order as a separate item)

DESCRIPTION	SUFFIX
Remote Test Switch (metal face plate)	RTS
Remote Text Switch (plastic face plate)	RTS-1

Power Consumption

Model	AC Input	Maximum		Stand-By (Ni-Cd, NiMH)*	
		Input Current	Input Power	Input Current	Input Power
MRT40	120VAC	0.25A	30W	0.1A	11W
	277VAC	0.12A	30W	0.05A	11W
MRTG	120VAC	0.95A	110W**	-	-
	277VAC	0.45A	110W**	-	-

* Stand-by power consumption is 50% lower for Lead-Calcium batteries

** Maximum power when equipped with 2 x 50W lamps (generator unit)

How to Order

SERIES	BATTERY TYPE	UNIT CAPACITY	AC INPUT	LAMP TYPE/WATTAGE	OPTIONS
Battery Unit= MRT	M= Lead-Calcium N= Nickel-Cadmium H= Nickel-Metal Hydride	40= 12V-40W	Blank= 120/277VAC	-2 (12)= 12W each head -2 (20)= 20W each head -2 (20H)= 20W, high lumen output -2 (LG)= MR16 LED, 12V-4W -2 (LJ)= MR16 LED, 12V-5W -2 (LJ)= MR16 LED, 12V-6W	-AD= Advanced Diagnostics (audible)* -ADNA= Advanced Diagnostics (non-audible)* -D1= Time Delay (5 minutes) -D2= Time Delay (10 minutes) -D3= Time Delay (15 minutes) -DL= Damp Location (only MRTN40, MRTH40)**
Generator Unit= MRT	G= Remote AC generator	Blank= Max. 100W	1= 120VAC 2= 277VAC	-2 (12)= 12W each head -2 (20)= 20W each head -2 (35)= 35W each head -2 (50)= 50W each head -2 (20H)= 20W, high lumen output -2 (35H)= 35W, high lumen output -2 (50H)= 50W, high lumen output -2 (LG)= 12V-4W, MR16 LED -2 (LJ)= 12V-5W, MR16 LED -2 (LJ)= 12V-6W, MR16 LED	-DL= Damp Location

Example: **MRTM40-2(20)-ADNA**

Dimensions

Dimensions are approximate and subject to change.

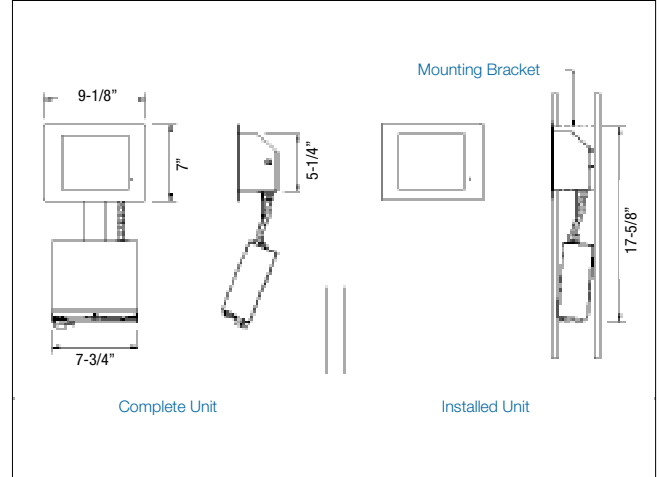

Unit Rating

Model	Watts to 87-1/2% of rated battery voltage*			
	1-1/2 hrs	2 hrs	3 hrs	4 hrs
MRT-40	40	30	24	-

* National Electrical Code Specification



TYPE: _____
 CATALOG #: _____
 NOTES: _____

Mini Inverter Series

Interruptible Unit Equipment

Features

- Lamps operated: Incandescent, LED, fluorescent lamps and ballast combinations, including triac dimmable ballasts (consult factory if DALI dimming)
- Components: High-efficiency pure sine wave inverter (250W and up), temperature-compensated charger, 12V oversized Valve Regulated Lead-Acid (VRLA) battery
- Construction: 14-gauge (400W & 720W) or 18-Gauge (125W & 250W) steel housing
- Emergency lighting supplied from one convenient source
- Input/Output voltage 120V 60 Hz or 277V 60 Hz
- Replacable output fuse protection
- Line voltage allows for remote mounting of emergency fixtures at distances up to 1000 feet
- Low Voltage Battery Disconnect
- Unit comes standard with electronic lockout and brownout circuits
- Meets or exceeds all National Electrical Code and Life Safety Code Emergency Lighting Requirements UL924 Listed
- Cabinet in factory white semi-gloss powder-coat paint finish
- May accept load to its full capacity when load feature power factor of 0.9 for 250W model and 0.8 for 125, 400 and 720W model
- Standard auto-diagnostic, non-audible, Nexus® system interface optional with an improved minimum load lost detection of 10%
- Standard lighting control override for 0-10V dimming systems

Highlights

The **Mini Inverter** is a UL Listed stand-alone pure sine wave (250W and up) output inverter designed to provide power to designated emergency lighting fixtures. In a power loss situation, it will supply power from the onboard battery supply.

The **Mini Inverter** works in conjunction with incandescent, LED, and fluorescent fixture types and will automatically run switched, normally-on, or normally-off designated emergency fixtures.

The **Mini Inverter** is ideal for applications requiring an emergency source for lighting arrangements that utilize multiple lamp and fixture types and is available in surface mount and comes with a three year warranty and seven-year pro-rata battery warranty.

Detailed warranty terms located at: www.emergi-lite.com/usa/files/EL_Warranty.pdf

Power Consumption And Unit Rating

MODEL NUMBER	AC SPECS	EMERGENCY POWER AVAILABLE FOR LOAD				
		90 MIN	2H	3H	4H	
EMIU-125	120/277VAC	1.15 / 0.70 Amps	125W	83W	62W	47W
EMIU-250		2.75 / 1.20 Amps	250W	167W	125W	94W
EMIU-400		4.60 / 2.00 Amps	400W	300W	200W	150W
EMIU-720		9.60 / 4.00 Amps	720W	480W	360W	270W

Electrical Characteristics & Dimensions

NOTE: For wiring diagram, please refer to the specification sheets.

POWER RATING	SINE WAVE	INSTALLATION	CABINET DIMENSIONS			NO. OF BATTERY	TOTAL WEIGHT	WEIGHT W/O BATTERY
			W"	H"	D"		120V & 277V	120V & 277V
125W	Modified	T-Bar	24"	6.5"	8"	1	50 lbs	22 lbs
125W	Modified	Wall	16.5"	12.2"	7.3"	1	50 lbs	22 lbs
250W	Pure	Wall	27"	12.2"	7.3"	2	100 lbs	45 lbs
400W	Pure	Wall	24"	10.5"	20"	2	150 lbs	65 lbs
720W	Pure	Wall	24"	14.5"	20"	2	220 lbs	95 lbs

How to Order

SERIES	CAPACITY	VOLTAGE	DIAGNOSTIC FEATURE	OPTIONS
EMIU	-125= 125W -250= 250W -400= 400W -720= 720W	BLANK= 120/120VAC or 277/277VAC	-Blank= Advanced-Diagnostic, non-audible* -AD= Advanced-Diagnostic, audible* -NEX= Nexus® wired -NEXRF= Nexus® wireless	-D1= Time Delay (5 minutes) -D2= Time Delay (10 minutes) -D3= Time Delay (15 minutes) -SAC= Service Alarm Contact* -T= Recessed T-Bar mounting (125W unit only)
			* Minimum load required: 10% of unit capacity	* Service alarm contact (SAC) shall provide a 24V signal, the charger board will indicate a fault by choosing a contact. Not available with 720 capacity

Example: EMIU-720

TYPE: _____
CATALOG #: _____
NOTES: _____

Low Capacity Mini Inverter Series

Interruptible Unit Equipment



Highlights

The **Low Capacity Mini Inverter** is a UL Listed, stand-alone pure sine wave output inverter designed to provide power to designated emergency lighting fixtures. In a power loss situation, it will supply power from the onboard battery supply.

The **Low Capacity Mini Inverter** works in conjunction with incandescent, LED, and fluorescent fixture types, and will automatically run switched, normally-on, or normally-off designated emergency fixtures.

The **Low Capacity Mini Inverter** is ideal for applications requiring an emergency source for lighting arrangements that utilize multiple lamp and fixture types. It is available in surface mount and T-grid (plenum rated). 3-year warranty and 7-year pro-rata battery warranty.

Features

- Operated lamps: Incandescent, LED, fluorescent and ballast combinations, including triac dimmable ballasts
- Components: True sinusoidal AC pulse width modulated design provides clean 60Hz. Emergency output
- “Soft Start” design reduces fixture inrush current and accepts load power factor range from 0.44 lead to 0.44 lag
- Construction: Heavy-duty steel cabinet. White powder paint coating provides scratch and corrosion resistance. Available for surface mount or T-grid installation (plenum rated)
- Emergency lighting supplied from one convenient source
- Input/output voltage: 120V 60 Hz or 277V 60 Hz
- Allows for remote mounting of emergency fixtures at distances of up to 1000 feet
- Maintenance-free Lead-Calcium battery
- Low voltage battery disconnect
- Unit comes standard with electronic lockout and brownout circuits
- Meets or exceeds all National Electrical Codes and Life Safety Codes or Life Safety Code Emergency Lighting Requirements
- Emergency Lighting Requirements UL924 Listed
- 3-year warranty and 7-year pro-rata battery warranty
Detailed warranty terms located at: www.emergi-lite.com/usa/files/EL_Warranty.pdf

Power Consumption And Unit Rating

NOTE: For wiring diagram, please refer to the specification sheets.

MODEL NUMBER	INPUT RATING	EMERGENCY POWER AVAILABLE FOR LOAD (90 MIN)
EMILC32	41VA	32W
EMILC55	64VA	55W

How to Order

SERIES	CAPACITY	VOLTAGE	BATTERY TYPE	MOUNTING
EMILC	32= 32W/VA 55= 55W/VA	BLANK= 120/277VAC	BLANK= Lead-Calcium	-S= Surface mount housing -T= Plenum rated ceiling T-grid mount housing

Example: **EMILC32-S**



www.emergi-lite.com

All information and specifications contained in this flyer are subject to change due to engineer design, errors and omissions. Illustrations and diagrams within this flyer may vary from actual products.

© 2017, Thomas & Betts Limited. All rights reserved. Printed in Canada 09/17/200. Order no. EL-US-NYCFLYER

Thomas & Betts
A Member of the ABB Group

