

Installation instructions

1. Remove the cover.
2. Install the gasket on the back plate.
3. Make the proper connections; see lamp voltage marking on the unit. Connect the lamp wires to the emergency circuit using wire nuts. For double head fixtures, lamps should be connected in parallel, not in series.
4. Fasten the back plate to the junction box.
5. Adjust the heads.
6. Secure the cover to the back plate with the screws provided.
7. Turn on power and check the operation of your lighting fixture.

Adjusting the heads

The head can be adjusted in two ways: by rotating it, and by tilting it.

Rotation: To rotate the heads, hold it and turn it either sides.

Tilt: To tilt the head, hold it and tilt upwards or downwards.

Lamps replacement

Refer to the relamping label located near the lamp holder or the recommended maximum wattage. Do not exceed recommended wattage.

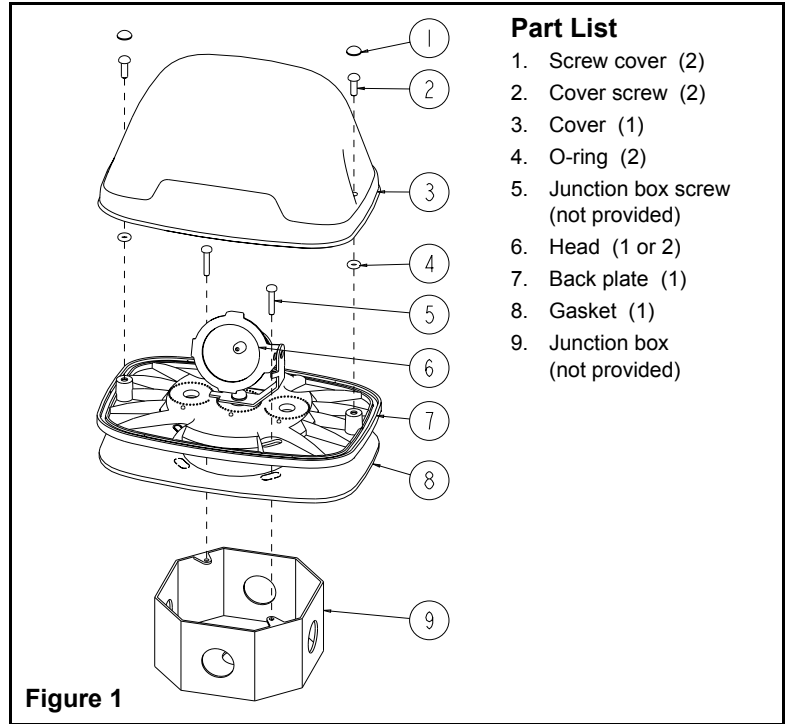

Part List

1. Screw cover (2)
2. Cover screw (2)
3. Cover (1)
4. O-ring (2)
5. Junction box screw (not provided)
6. Head (1 or 2)
7. Back plate (1)
8. Gasket (1)
9. Junction box (not provided)

Figure 1

Installation instructions

1. Remove the cover
2. Install the gasket on the back plate.
3. Make the proper connections; see lamp voltage marking on the unit. Connect the lamp wires to the emergency circuit using wire nuts. For double head fixtures, lamps should be connected in parallel, not in series.
4. Fasten the back plate to the junction box.
5. Adjust the heads.
6. Secure the cover to the back plate with the screws provided.
7. Turn on power and check the operation of your lighting fixture.

Adjusting the heads

The head can be adjusted in two ways: by rotating it, and by tilting it.

Rotation: To rotate the heads, hold it and turn it either sides.

Tilt: To tilt the head, hold it and tilt upwards or downwards.

Lamps replacement

Refer to the relamping label located near the lamp holder or the recommended maximum wattage. Do not exceed recommended wattage.

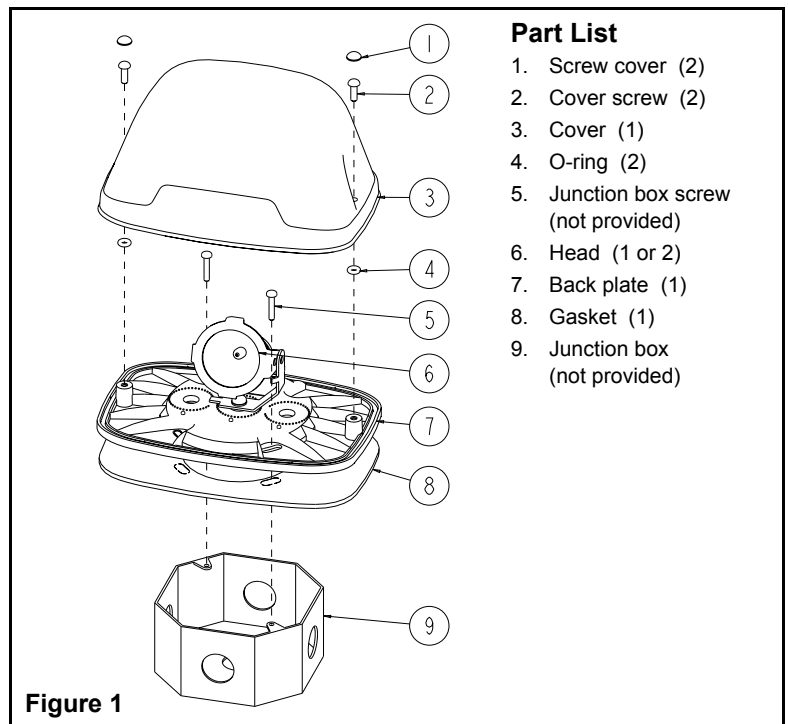

Part List

1. Screw cover (2)
2. Cover screw (2)
3. Cover (1)
4. O-ring (2)
5. Junction box screw (not provided)
6. Head (1 or 2)
7. Back plate (1)
8. Gasket (1)
9. Junction box (not provided)

Figure 1