



PROVIDER

PRO-2/Pro-3 Series 6 Volt

Listed to UL 924 Standard

Sealed Maintenance-Free Battery

- Lead Calcium



General Information

PROVIDER is the new look in emergency lighting design. Its sleek low profile body and transparent lamp shield combine to make a contemporary style that's just right for today's aesthetic demands. Whether it is featured in its standard off-white color or optional black, the PROVIDER will compliment a variety of interiors in stores, offices, theaters, restaurants and shopping malls. PROVIDER is versatile too, its body, measuring only 11" x 5", can be mounted in any orientation on walls or ceilings.

Standard Features

- Completely self-contained
- UL listed to Standard 924
- 120/277 Vac, 0.1/0.05 Amp, input standard
- Fully adjustable self-locking heads
- 6 volt High Intensity Tungsten (HIT) lamps and mirrored reflectors supply generous amounts of emergency lighting.
- Maintenance-free recombination battery provides 90 minutes of emergency operation.
- Reliable integrated circuitry:
- Constant potential, temperature compensated, current limited charger recharges the battery to rated capacity per UL Standard 924
- Low Voltage Battery Disconnect prevents deep discharge damage
- Brownout Protection-when utility power drops so low that area lighting lamps dim or extinguish, the PROVIDER will automatically activate
- Battery Lockout-saves labor and prevents battery discharge during installation
- Instantaneous transfer
- Long life LED charge monitor light
- Rocker type test switch
- Sealed, dust-tight transfer relay

Advanced Diagnostics (optional)

Enjoy the peace of mind provided by Emergi-Lite's advanced diagnostic circuitry. The AD circuit monitors the every critical function of the unit and provides an audible and visual indicator when a fault is detected. Non-audible versions available as well.

Fast and Easy Installation

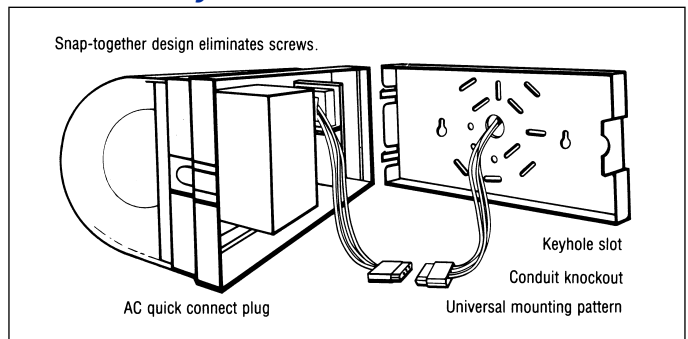

PROVIDER'S AC quick-connect plug, battery lockout feature and snap-together design make installation fast and easy.

With the AC quick-connect plug, contractors simply make the AC connection to the plug, mount the back plate and plug in the unit.

The battery lockout feature is an AC activated load switch that prevents the batteries from discharging until the unit is energized with AC power. This allows the contractor to install the unit and connect the batteries in one convenient operation.

A universal mounting pattern, keyhole slots and a conduit knock-out provide alternate mounting methods.

The PRO-2 / Pro-3 can be mounted in any orientation on walls or ceilings.

Outline and Dimensions

Dimensions are approximate and subject to change.

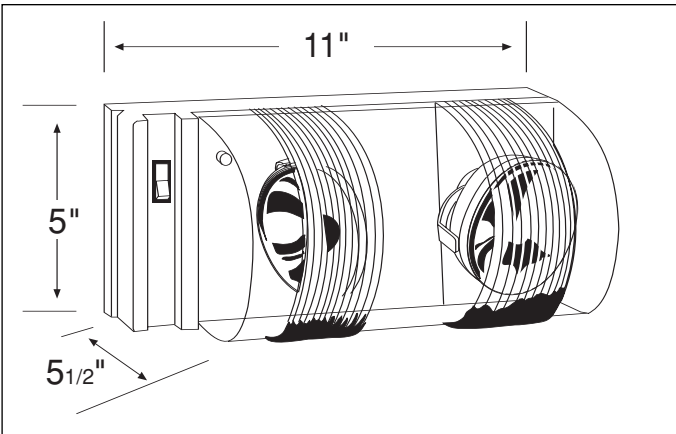

Unit Rating Chart

Each unit furnished with one HIT lamp per head.

| PROVIDER BATTERY UNIT | | | | | | |
|---------------------------------------|--------------|--------------|---|-------|-------|-------|
| Sealed Maintenance-Free Battery Types | D.C. Voltage | Model Number | *Watts to 87 % of rated battery voltage | | | |
| | | | 1 1/2 hrs | 2 hrs | 3 hrs | 4 hrs |
| Lead-Calcium | 6 | PRO-2 | 12 | 9.5 | - | - |
| | 6 | PRO-3 | 18 | 12 | 10 | 7 |

| PROVIDER REMOTE LIGHTING FIXTURES | | | |
|-----------------------------------|--------------|--------------|--------------------|
| Lamp | D.C. Voltage | Model Number | Total Unit Wattage |
| 570.0012 | 6 | 6PRO-10 | 10.8 |
| 570.0025 | 12 | 12PRO-2 (ZF) | 18 |
| 570.0045 | 24 | 24PRO-2 (ZN) | 18 |

Optional Features

| | |
|--|-----------------|
| Advanced Diagnostics | -AD |
| Advanced Diagnostics, Non-Audible..... | -ADNA |
| Damp Location | -DL |
| Voltmeter | -VM* |
| Vandal resistant (screws) | -VR |
| Black housing | -B |
| Unit with cord set | -C** |
| Replacement Lamps..... | 570.0012 |

* Not available with AD/ADNA Options.

** Standard cord is 3 ft. custom lengths available.

NOTE: Certain option combinations may affect the listing.

Please contact the factory for specifics.

How To Order

| | |
|---|--------------------------------|
| For standard Provider unit | Model # PRO-2 |
| Remote Capacity Provider (11 watts) | PRO-3 |

Provider remote lighting fixtures (Requires an external DC source)

| | |
|---------------------------------|--------------------|
| 6V 10.8W Total Unit Power | 6PRO-10 |
| 12V 18W Total Unit Power | 12PRO-2(ZF) |
| 24V 18W Total Unit Power | 24PRO-2(ZN) |

Suggested Specification

Supply and install Emergi-Lite Model PRO-2, 6 volt, 12 watt emergency lighting unit. Unit shall be fully automatic, self-contained, maintenance-free and listed to UL Standard 924.

Circuitry- shall include a 120/277 volt dual input transformer, automatic charging, instantaneous transfer, test switch, long life LED AC charge monitor light. The charger shall utilize a computer tested integrated circuit which samples the battery in relation to its temperature, state of charge and input voltage fluctuations. The charger shall be current limited, temperature compensated, short-circuit protected and reverse polarity protected. The charger shall recharge the battery to rated capacity as per UL924 specifications. Electrical features shall include a Low Battery Voltage Disconnect circuit to protect the battery from deep discharge damage. Brownout protection for automatic unit operation when utility power drops low enough to dim incandescent lamps and extinguish fluorescent and HID lamps. Battery lockout feature to prevent battery discharge during installation to a non-energized circuit.

Battery- shall be 6 volt, maintenance-free and have the electrolyte in a sealed case. To prevent loss of electrolyte through gassing, the battery shall operate by the principle of electrolyte recombination.

Housing- Heads and Shield- The housing and heads shall be constructed of high impact, UL 94-5VA flame classification off white thermoplastic. The unit shall resist denting, peeling, scratching and corrosion. Heads shall have High Intensity Tungsten (HIT) lamps mounted in polished reflectors. The transparent lamp shield shall be constructed of acrylic.

Mounting- The unit shall be mountable in any orientation, on walls or ceilings. A universal mounting pattern, rear key-hole slots, and conduit entry on one end shall be provided. The lamp shield, housing and backplate shall be designed for snap-together assembly to eliminate screws and facilitate easy installation.

*Unit Warranty

Entire unit (excluding lamps) carries a 3-year Full Warranty.

*Battery Warranty

Sealed Lead Calcium: 8-year life expectancy. 3-year Full Warranty, plus 3-year pro rata warranty.

**Subject to proper installation and maintenance.*