

Unit Equipment Accessories

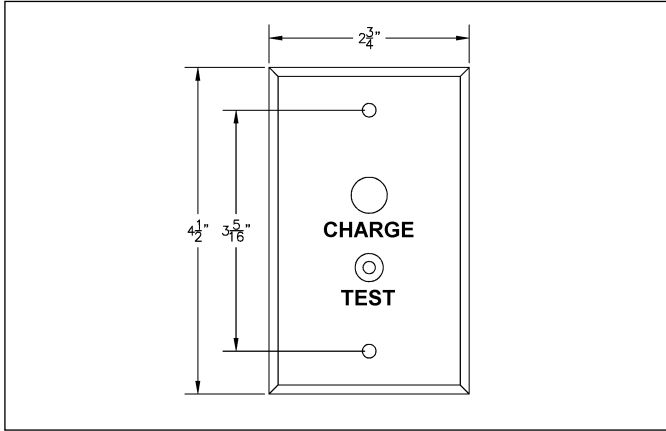

Remote Test switch

Make testing your ceiling mounted equipment easier with the remote test switch. Compatible with 120 or 277 VAC circuits, the remote test switch will interrupt the line voltage to your equipment by means of a momentary push button switch. AC on/Charge status indicator lamp assures that power is going to your emergency lighting.

How To Order

RTS.....Metal faceplate, chrome
RTS-1.....Plastic Faceplate, off white

Mounting Brackets and Platforms

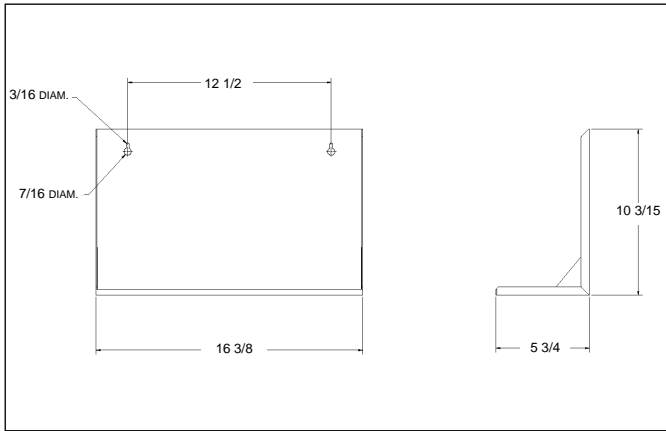

MP3, Mounting Platform

Constructed of 18 GA. steel, the MP3 mounting platform will accommodate any of our unit equipment in our 'B' cabinet.

How To Order

MP3.....Mounting platform, whist
MP3G.....Mounting platform, gray

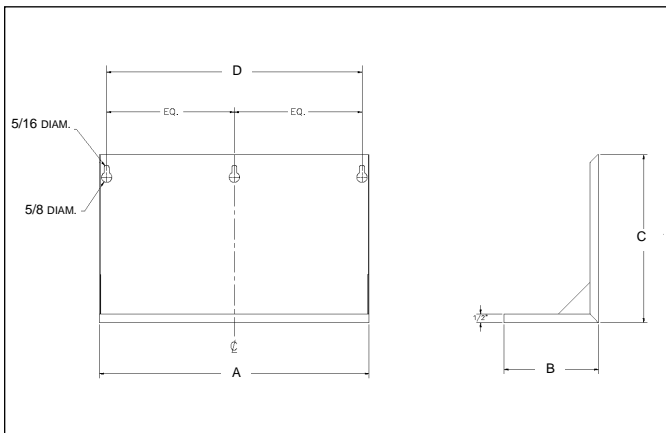

MP6, MP12, MP24 Mounting Platform

Constructed of 18 GA. Steel, the MP6, MP12, and MP24 mounting platform will accommodate our unit equipment in our 'C', 'D', and 'E' cabinets respectively.

How To Order

MP6.....Mounting platform, whist
MP12.....Mounting platform, whist
MP24.....Mounting platform, whist
Optional colors available, contact factory

Part #	A	B	C	D
MP6	17"	7.75"	12.25"	16"
MP12	27.5"	7.75"	12.25"	16"
MP24	27.5"	11.63"	12.25"	16"

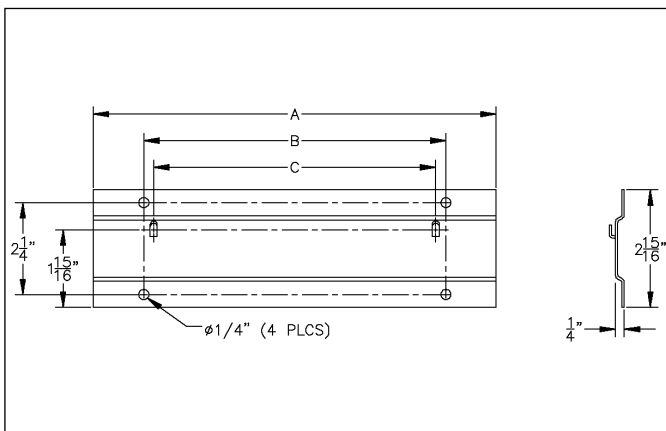

B1 and B2 Mounting Brackets

Constructed of 16 GA. steel, the B1 and B2 mounting bracket will accommodate our unit equipment in our 'A' and 'B' cabinets respectively.

How To Order

B1.....Mounting bracket, whist
B2.....Mounting bracket, whist

Part #	A	B	C
B1	10"	7 1/2"	7"
B2	14 1/4"	12 5/8"	11 3/4"