

Fluorescent Packs **FPS-R & FPS-T Series**

The **FPS-R & FPS-T Series** was developed to eliminate unsightly conventional emergency lighting units and at the same time incorporate the emergency lighting unit into the normal fluorescent lighting system. In this way, high lumen levels can be maintained during a power failure without interrupting the lighting design.

Sealed Maintenance-Free Batteries

- Nickel Cadmium • Pure Lead • Lead Calcium

Unit Rating Chart

REMOTE MOUNTED (FPS-R)				
Unit Type	Lumens*	Battery Suffix	Sealed Maintenance-Free Battery Types	Number of Lamps
FPS-R	720	C	Nickel Cadmium	1
FPS-R	720	E	Pure Lead	1
FPS-R	720	M	Lead Calcium	1
FPS-R	1800	C	Nickel Cadmium	1
FPS-R	1800	E	Pure Lead	1
FPS-R	1800	M	Lead Calcium	1
T-BAR MOUNTED (FPS-T)				
FPS-T	720	C	Nickel Cadmium	1
FPS-T	720	E	Pure Lead	1
FPS-T	720	M	Lead Calcium	1
FPS-T	1800	C	Nickel Cadmium	1
FPS-T	1800	E	Pure Lead	1
FPS-T	1800	M	Lead Calcium	1
FPS-T	720	C	Nickel Cadmium	2
FPS-T	720	E	Pure Lead	2
FPS-T	720	M	Lead Calcium	2
FPS-T	1800	C	Nickel Cadmium	2
FPS-T	1800	E	Pure Lead	2
FPS-T	1800	M	Lead Calcium	2

*Lumens in emergency mode on typical F-40 type lamps

Outline and Dimensions

Dimensions are approximate and subject to change.

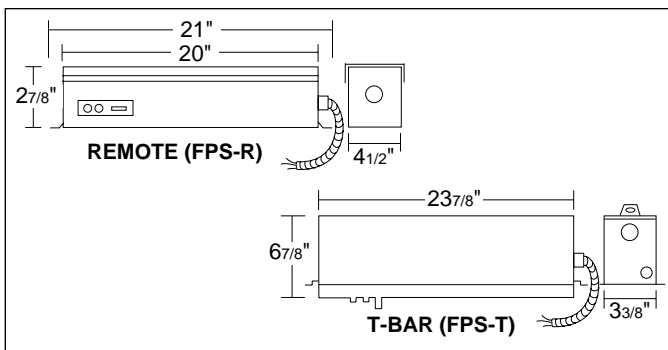

How To Order (example)

FPS	-	T	-	720	-	M	-	1	-	RTS
Series		Cabinet Type		Lumens		Battery Type lead calcium		# of lamps operating		Option



Standard Features

Reliability

The FPS-R & FPS-T Series comes complete with a 3-year full warranty. Each unit is fully computer tested.

Unit Data

All metal construction with white baked enamel finish and 3" pre-wired fixture whip. During normal operation, when unswitched AC is present, the fixture will be fully illuminated by means of the regular ballast. At the same time, the emergency ballast is supplied with AC, which transforms and rectifies into a low DC voltage to recharge the battery and maintains it in a fully charged condition. When the AC fails, a solid state voltage sensor instantly turns on a high frequency inverter which illuminates one or two* lamps in the fixture for a minimum of 90 minutes. At the end of the rated time a low voltage sensor disconnects the battery to prevent over-discharging. When the AC returns, the inverter switches off and the battery begins to recharge. *Available in FPS-T only, can run 2 lamps in a 2 or 4 lamp fixture.

PulsePlus Charger

PulsePlus circuitry offers 120/277 volt input 60 Hz., 0.3 Amp (other inputs available), fused output circuit(s), dual diagnostic indicator lights, temperature compensation, sealed relay, low voltage battery disconnect, brownout protection and lockout (automatic battery connect).

Optional Features

Description

Add Suffix

Remote test switch.....RTS-1
Available for installation where routine testing via the units standard integral test switch would be difficult due to either fixture location or inaccessibility. This option consists of a push button test switch and pilot light, mounted on a single gang switch plate.

Cabinets

Remote: (external) mounts on top or beside fixture. #18 Gauge steel, finish white baked enamel and pre-wired 3" flexible conduit fixture whip.

T-Bar: mounts in T-Bar struts beside fixture. #18 Gauge steel, finish white baked enamel and mounting eyes for fixture suspension and a pre-wired 3" flexible conduit fixture whip.

Servicing: Backplate lifts off for access to battery and input/output wires.