

Fluorescent Packs FPS-R & FPS-T Series

The **FPS-R & FPS-T Series** was developed to eliminate unsightly conventional emergency lighting units and at the same time incorporate the emergency lighting unit into the normal fluorescent lighting system. In this way, high lumen levels can be maintained during a power failure without interrupting the lighting design.

Sealed Maintenance-Free Batteries

- Nickel Cadmium • Pure Lead • Lead Calcium

Unit Rating Chart

REMOTE MOUNTED (FPS-R)				
Unit Type	Lumens*	Battery Suffix	Sealed Maintenance-Free Battery Types	Number of Lamps
FPS-R	720	C	Nickel Cadmium	1
FPS-R	720	E	Pure Lead	1
FPS-R	720	M	Lead Calcium	1
FPS-R	1800	C	Nickel Cadmium	1
FPS-R	1800	E	Pure Lead	1
FPS-R	1800	M	Lead Calcium	1
T-BAR MOUNTED (FPS-T)				
FPS-T	720	C	Nickel Cadmium	1
FPS-T	720	E	Pure Lead	1
FPS-T	720	M	Lead Calcium	1
FPS-T	1800	C	Nickel Cadmium	1
FPS-T	1800	E	Pure Lead	1
FPS-T	1800	M	Lead Calcium	1
FPS-T	720	C	Nickel Cadmium	2
FPS-T	720	E	Pure Lead	2
FPS-T	720	M	Lead Calcium	2
FPS-T	1800	C	Nickel Cadmium	2
FPS-T	1800	E	Pure Lead	2
FPS-T	1800	M	Lead Calcium	2

*Lumens in emergency mode on typical F-40 type lamps

Outline and Dimensions

Dimensions are approximate and subject to change.

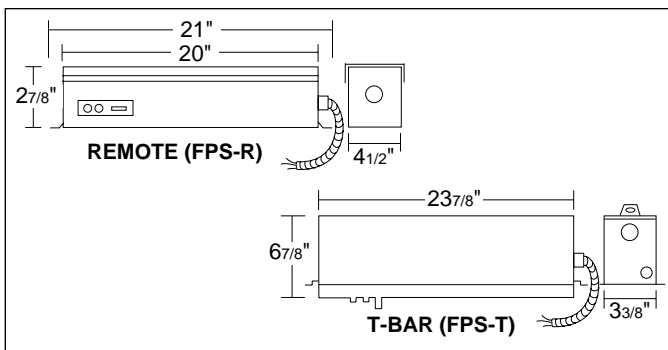

How To Order (example)

FPS	-	T	-	720	-	M	-	1	-	RTS
Series		Cabinet Type		Lumens		Battery Type lead calcium		# of lamps operating		Option



Standard Features

Reliability

The FPS-R & FPS-T Series comes complete with a 3-year full warranty. Each unit is fully computer tested.

Unit Data

All metal construction with white baked enamel finish and 3" pre-wired fixture whip. During normal operation, when unswitched AC is present, the fixture will be fully illuminated by means of the regular ballast. At the same time, the emergency ballast is supplied with AC, which transforms and rectifies into a low DC voltage to recharge the battery and maintains it in a fully charged condition. When the AC fails, a solid state voltage sensor instantly turns on a high frequency inverter which illuminates one or two* lamps in the fixture for a minimum of 90 minutes. At the end of the rated time a low voltage sensor disconnects the battery to prevent over-discharging. When the AC returns, the inverter switches off and the battery begins to recharge. *Available in FPS-T only, can run 2 lamps in a 2 or 4 lamp fixture.

PulsePlus Charger

PulsePlus circuitry offers 120/277 volt input 60 Hz., 0.3 Amp (other inputs available), fused output circuit(s), dual diagnostic indicator lights, temperature compensation, sealed relay, low voltage battery disconnect, brownout protection and lockout (automatic battery connect).

Optional Features

Description

Add Suffix

Remote test switch.....RTS-1
Available for installation where routine testing via the units standard integral test switch would be difficult due to either fixture location or inaccessibility. This option consists of a push button test switch and pilot light, mounted on a single gang switch plate.

Cabinets

Remote: (external) mounts on top or beside fixture. #18 Gauge steel, finish white baked enamel and pre-wired 3" flexible conduit fixture whip.

T-Bar: mounts in T-Bar struts beside fixture. #18 Gauge steel, finish white baked enamel and mounting eyes for fixture suspension and a pre-wired 3" flexible conduit fixture whip.

Servicing: Backplate lifts off for access to battery and input/output wires.

Emergency Lighting Fluorescent Packs **FPDL Series**

The **FPDL Series** are self-contained emergency power packs used to convert compact fluorescent recessed downlight fixtures into emergency lights. Operation is automatic. In the event of a power failure, the FPDL Series will cold strike and operate a single lamp in a fixture for 90 minutes. Installation does not affect normal lamp operation.

UL Listed

UL listed to Standard 924. New York City approved

Sealed Maintenance-Free Batteries

- Nickel Cadmium



Standard Features

Reliability

The FPDL Series comes complete with a 3-year full warranty. Each unit is fully computer tested.

Unit Data

The FPDL Series is 120/277 dual voltage and compatible with normal and high power factor ballasts. Units are UL listed for new or retrofit installation with indoor fixtures, not for use in hazardous areas or in heated air outlets. The maintenance free nickel cadmium batteries provide 90 minutes of emergency operation. A test switch with pilot light can be mounted on the wall or ceiling.

Application

The FPDL 7-13 and FPDL 18-26 are designed to operate with most single or double recessed downlight fixtures NOTE: Must be used with single lamp ballast only. The FPDL 10-42 can be used with most 10-42 watt 4 pin quad and triple compact fluorescent lamp, with (1) lamp 650 lumens and (2) lamps 350 lumens each lamp output. Check fixture and application for mounting and connecting space.

Installation Kit

The FPDL Series is installed within two feet of the recessed downlight. The installation kit includes a power pack, two 24 inch flex cables with end connectors, a charge indicator light and test switch preassembled to a trim plate. A switch box is included with the FPDL 7-13 and FPDL 10-42. Mounting hardware and fixture supplied by other.

Outline and Dimensions

Dimensions are approximate and subject to change.

CATALOG NUMBER	DIMENSIONS			
	A	B	C	D
FPDL 7-13	9 7/16"	8 7/8"	2 3/8"	1 1/2"
FPDL 10-42	9 1/2"	9"	2 3/8"	1 1/2"
FPDL18-26	11 7/8"	11 5/8"	2 3/8"	1 1/2"

Lamp Operation

FPDL7-13 Series

Lumens: 650

Lamps Operated in Emergency (90 minutes): (1) 2 pin compact fluorescent lamp 7w, 9w or 13w

Lamps Types: 7w or 9w twin tube, double twin tube, 180ma, or 13w twin tube, double twin tube, 285ma fluorescent.

Base Types: G23, GX23, G23-2, GX23-2, G242-1

FPDL18-26 Series

Lumens: 650

Lamps Operated in Emergency (90 minutes): (1) 2 pin compact fluorescent lamp 10w, 13w, 18w or 26w

Lamps Types: one or two twin tube, double twin tube (quad), or triple twin tube compact fluorescent

Base Types: G24d-1, G24d-2 and G24d-3

FPDL10-42 Series

Lumens*: (1) lamp 650, (2) lamps 350 each lamp output

Lamps Operated in Emergency (90 minutes): (1) 10-42 watt or (2) 10-26 watt

Lamps Types: 10-42 watt 4 pin, rapid start compact lamps (twin tube, triple tube, quad, 2D and stright)

Base Types: G24q-1, G24q-2, G24q-3, 2G10, 2G11, med. bipin and GR10q

Optional damp location listing available.

How To Order

Simple specify model number:

FPDL 7-13

FPDL 18-26

FPDL 10-42

FPDL10-42DL Damp location listed.